

PREMIUM EFFICIENCY WASHDOWN DUTY

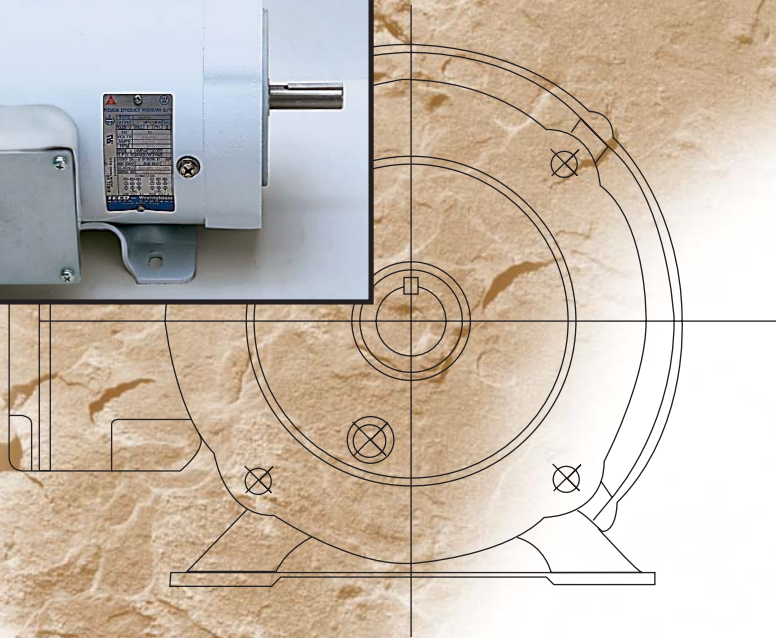
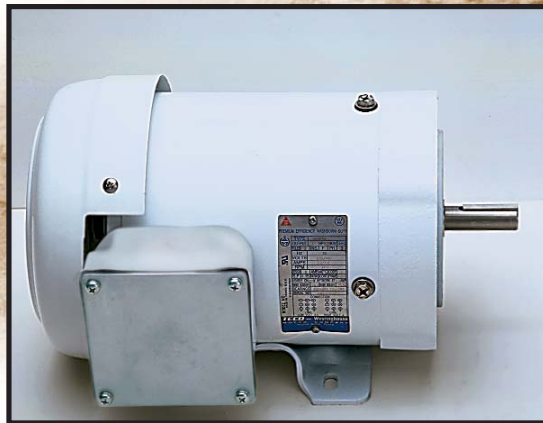

DIMENSIONS

Totally Enclosed Fan Cooled, C-face with rigid base mount, type AEGECW, AEGEFW (Frames 56C, 143TC and 145TC, rolled steel construction) and AEHECW (Frames 182TC and 184TC, cast iron construction).

Figure 1 A56C

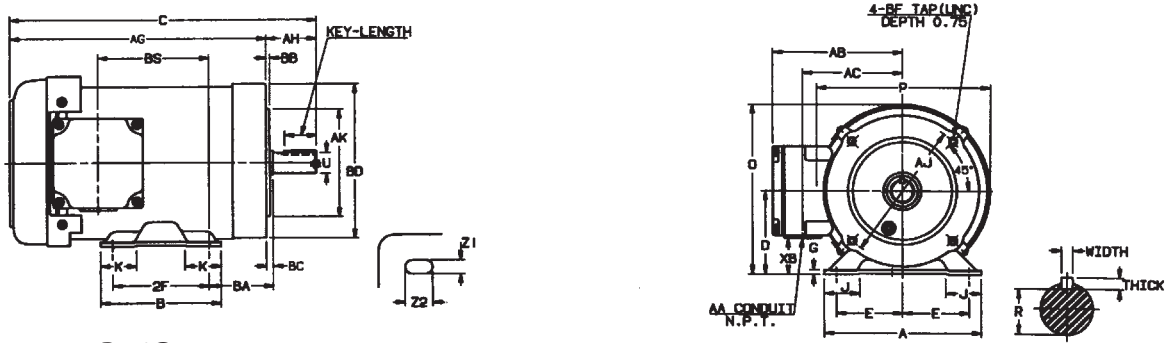

Figure 2 B56C
C56C

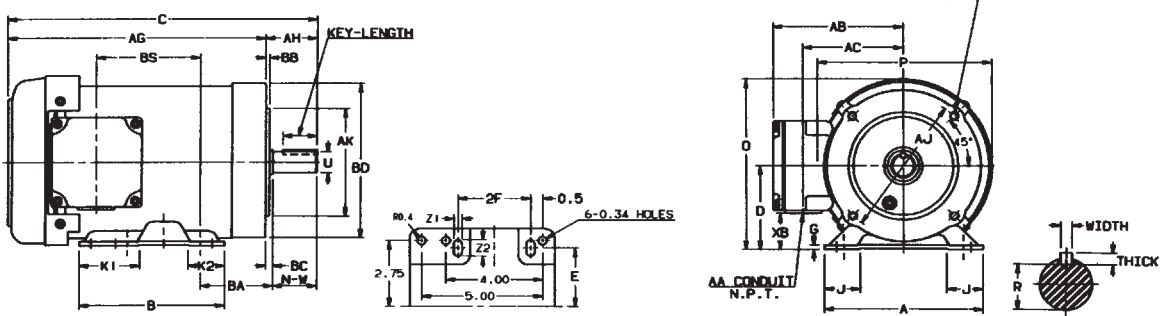

Figure 3 143TC
145TC

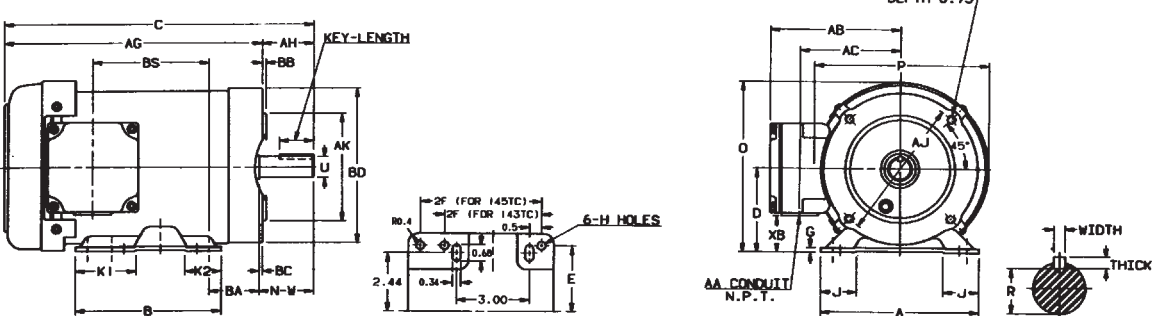
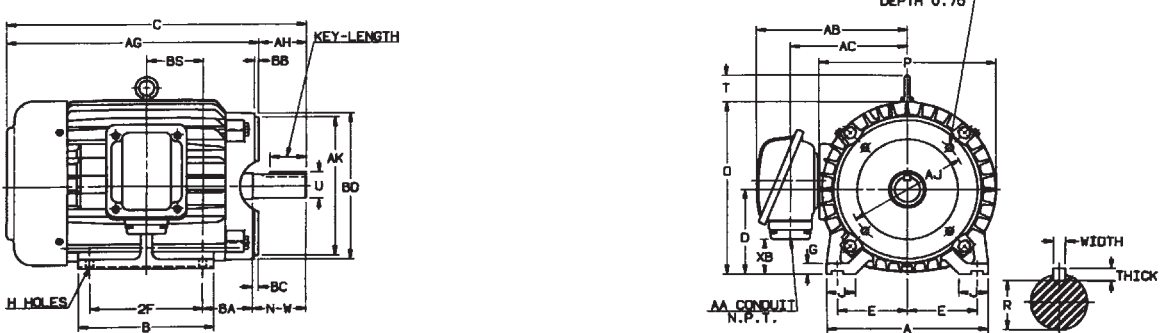
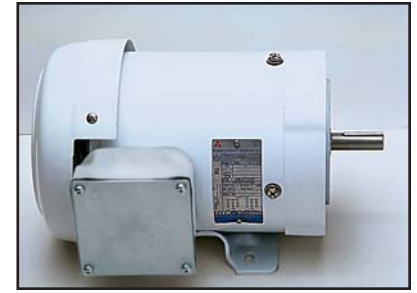

Figure 4 182TC
184TC



PERFORMANCE DATA

Totally Enclosed Fan Cooled, Premium Efficiency
 C-face mount with rigid base, type AEGECW, AEGEFW, AEHECW
 Three phase, 60Hz, 230/460V (usable on 208V); 575V
 NEMA Design B, Continuous Duty
 Class F insulation with Class B temperature rise
 40°C Ambient Temperature, 1.15 Service Factor



HP	Full Load RPM	Frame No.	Product Item Number	Full Load				Current Amps @230V	Locked Rotor Current		Break-Down Torque % FLT	Rotor WR ² lb-ft ²	NEMA Code Letter	Approx. Weight lbs.
				Torque lb-ft	Eff. (%)	P.F. (%)	Torque % FLT		Amps @230V					
1/2	3445	A56C	AEGECW-02-00005YH	0.8	70.0	80.0	1.7	400	12.0	395	0.028	L	32	
	1740	A56C	AEGECW-04-00005YH	1.5	72.0	69.0	1.9	270	12.0	375	0.059	L	32	
3/4	3420	A56C	AEGECW-02-00007YH	1.2	76.0	84.0	2.2	310	15.0	345	0.033	J	34	
	1740	A56C	AEGECW-04-00007YH	2.3	73.0	66.0	2.9	310	20.0	395	0.069	M	34	
1	3439	A56C	AEGECW-02-00010YH	1.5	78.5	83.0	2.9	266	20.0	339	0.037	J	34	
	1743	B56C	AEGEFW-04-00010YH	3.0	84.0	79.0	2.8	330	23.0	401	0.105	L	36	
	1743	143TC	AEGECW-04-00010YH	3.0	84.0	79.0	2.8	330	23.0	401	0.105	L	36	
1 1/2	3456	B56C	AEGEFW-02-00015YH	2.3	84.0	82.0	4.1	522	33.0	456	0.050	K	37	
	3456	143TC	AEGECW-02-00015YH	2.3	84.0	82.0	4.1	522	33.0	456	0.050	K	37	
	1733	C56C	AEGEFW-04-00015YH	4.5	84.0	84.0	4.0	264	30.0	362	0.131	J	47	
	1733	145TC	AEGECW-04-00015YH	4.5	84.0	84.0	4.0	264	30.0	362	0.131	J	47	
2	3472	C56C	AEGEFW-02-00020YH	3.0	84.0	84.0	5.3	400	48.0	477	0.065	L	47	
	3472	145TC	AEGECW-02-00020YH	3.0	84.0	84.0	5.3	400	48.0	477	0.065	L	47	
	1735	C56C	AEGEFW-04-00020YH	6.1	84.0	81.0	5.5	334	44.0	400	0.146	K	47	
	1735	145TC	AEGECW-04-00020YH	6.1	84.0	81.0	5.5	334	44.0	400	0.146	K	47	
3	3495	182TC	AEHECW-02-00030YH	4.5	87.5	90.5	7.1	280	64.0	340	0.190	K	105	
	1755	182TC	AEHECW-04-00030YH	8.9	88.5	82.5	7.7	240	64.0	350	0.349	K	110	
5	3480	184TC	AEHECW-02-00050YH	7.5	88.5	92.5	11.4	290	92.0	320	0.272	J	121	
	1750	184TC	AEHECW-04-00050YH	15.0	89.5	86	12.2	210	92.0	320	0.500	J	130	
7 1/2	3510	213TC	AEHECW-02-00075YH	11.2	91.0	89	17.3	200	127.0	275	0.448	H	172	
	1755	213TC	AEHECW-04-00075YH	22.4	91	86.5	17.8	270	127.0	300	0.790	H	182	
10	3510	215TC	AEHECW-02-00100YH	15.0	91	90.5	22.7	220	162.0	260	0.573	H	200	
	1755	215TC	AEHECW-04-00100YH	30.0	91	88.5	23.3	260	162.0	290	1.024	H	205	

- Note:
1. Meet or exceed the requirements of EPACT '92.
 2. The above are typical values based on test.
 3. Actual load and full voltage testing: According to ANSI/IEEE standard 112-1991 method B.
 4. Data subject to change without notice.

CONSTRUCTION FEATURES

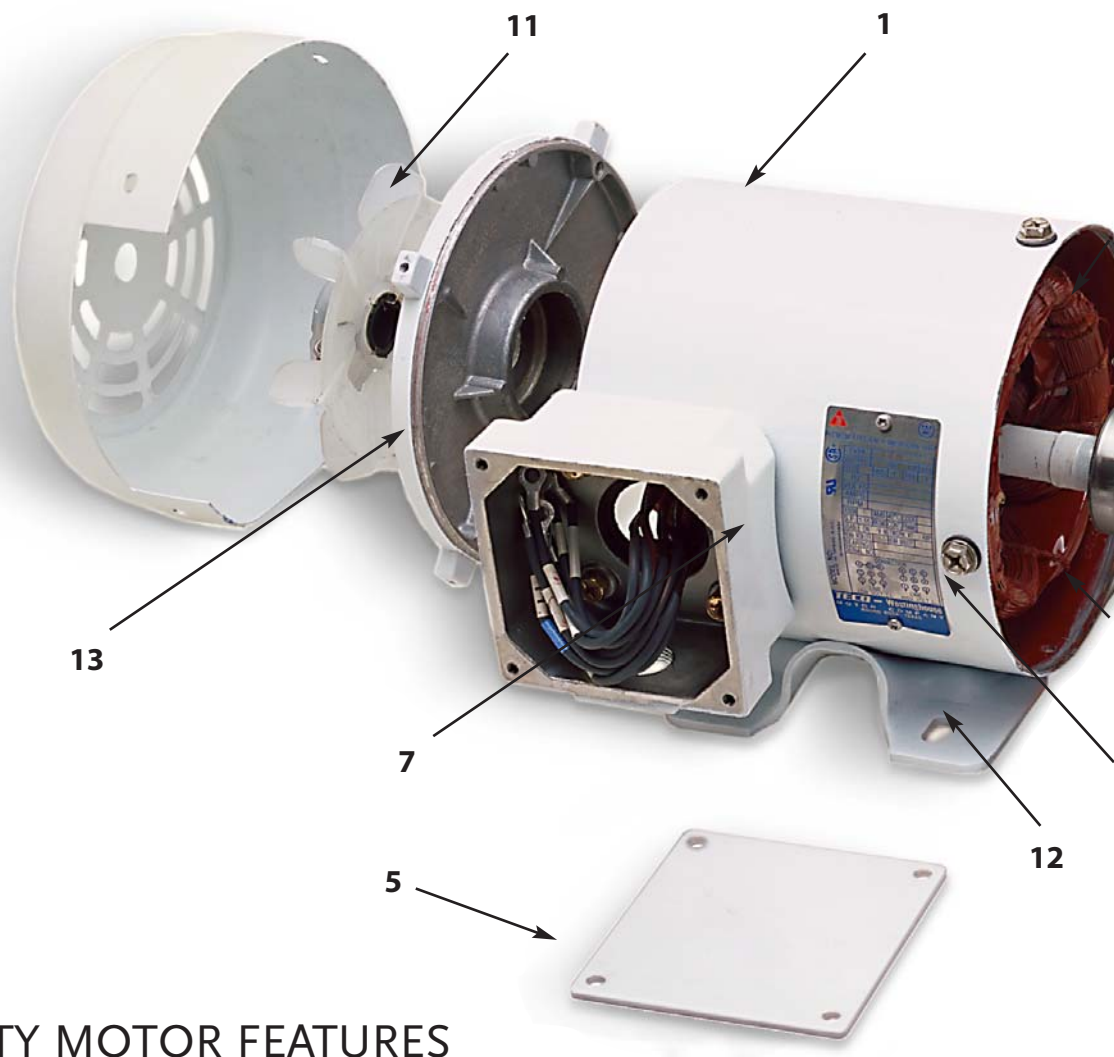

WASHDOWN DUTY MOTOR FEATURES

The TECO–Westinghouse WASHDOWN DUTY MOTOR is designed to last for use in applications where the motor is exposed to a high humidity environment and frequent high pressure washdown such as food processing.

1. All exterior surfaces are finished with USDA approved two part epoxy paint to protect against rust, corrosion and chemical attack, and meeting the sanitary requirements.
2. Double Sealed oversized bearings with Chevron SRll type or equivalent high temperature/moisture resistant greases for longer bearing life.
3. Contact lip seal and V-ring on both endbell and C-face protect both bearings from moisture.
4. Corrosion resistant cast iron C-face for rigidity.
5. Stainless steel hardware to prevent rust and corrosion.
6. Drain holes in frame, endbell and C-face to allow condensation to drain.
7. Threaded and fully gasketed stainless steel (2HP and below)/cast iron (3-10HP) oversized conduit box to seal out moisture.
8. No. 304 stainless steel shaft and special rotor rust-resistant treatment.

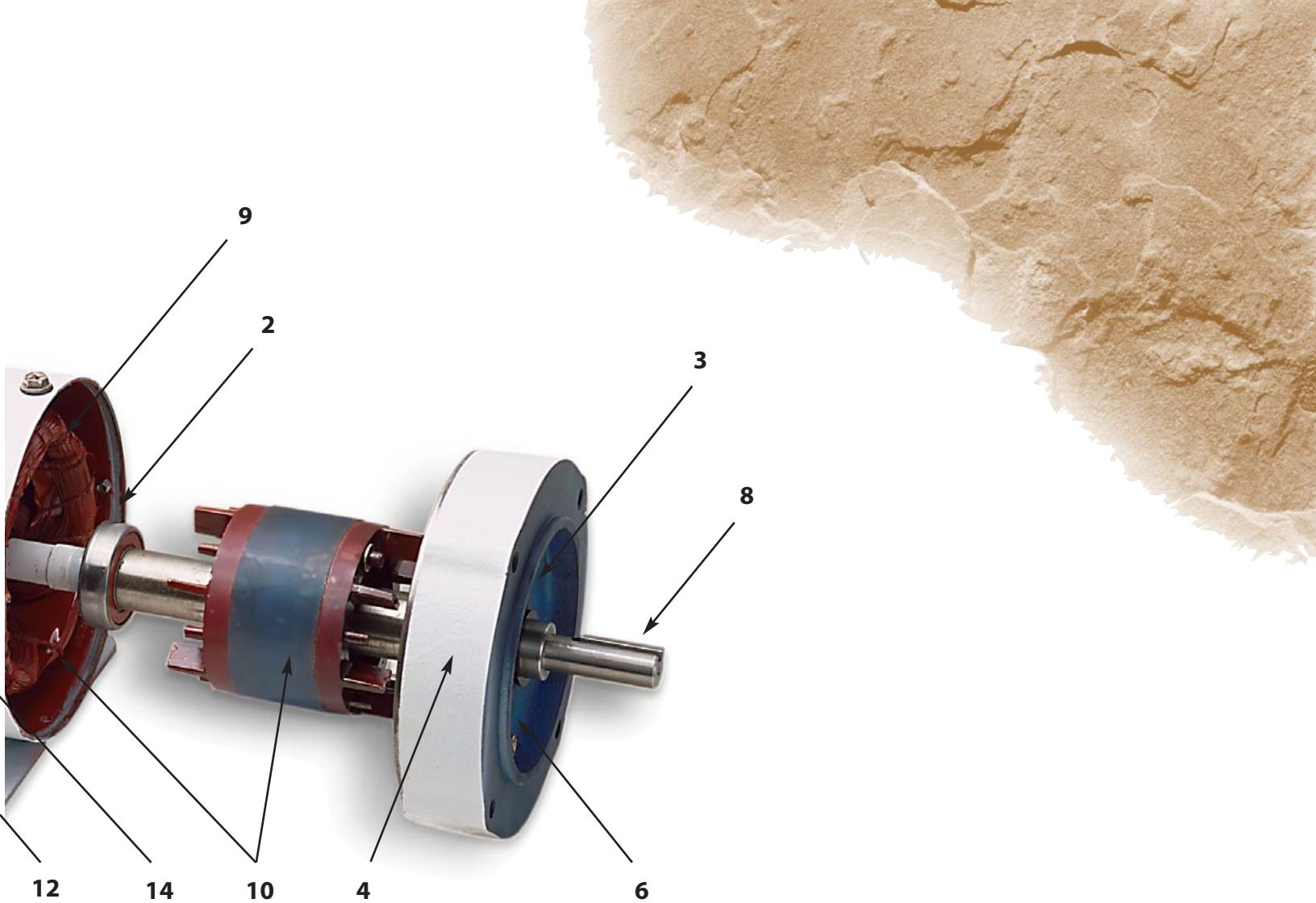

- 9. Class F non-hygroscopic insulation system with Class B temperature rise at 1.15 service factor for extended insulation life and reliability.
- 10. All machined surfaces and interior frame, endbell, C-face are treated for rust and corrosion resistance.
- 11. Corrosion-resistant high-strength plastic external fan.
- 12. Flexible dual-mounting holes (56 and 140T) in 1, 1½ and 2HP motors.
- 13. Permatex or equivalent sealer in all fasteners and machine joints to seal out moisture.
- 14. Stainless steel nameplate.

TYPICAL APPLICATIONS

DAIRIES

MEAT PACKING PLANTS

SAUSAGE & PREPARED MEAT PRODUCTS

POULTRY PROCESSORS

CREAMERY

NATURAL & PROCESSED CHEESE MANUFACTURING

FRUIT & VEGETABLE CANNERS & PACKAGERS

FROZEN FRUIT & VEGETABLE MANUFACTURERS

BEVERAGE MANUFACTURERS

SOFT DRINK & CARBONATED WATER MANUFACTURERS

SEAFOOD PROCESSORS

CAR WASHES

DIMENSIONS

Totally Enclosed Fan Cooled, C-face with rigid base mount, type AEHECW (Frames 213TC and 215TC, cast iron construction).

Figure 5 213TC
215TC

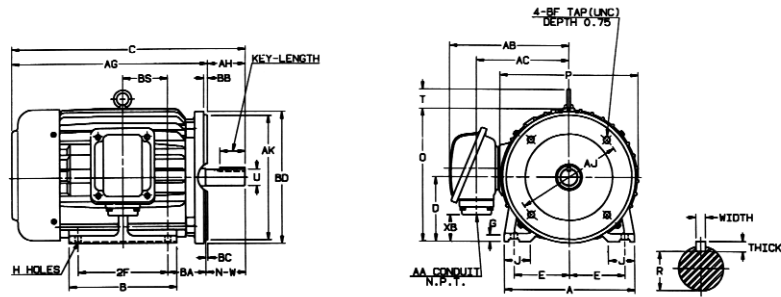

Output (HP)		Frame No.	Fig. No.	A	B	C	D	E	2F	G	H	J	K	K1	K2	O	P	T	Z1	Z2	AG	AH
2P	4P																					
1/2	1/2	A56C	1	6.38	5.00	11.83	3.50	2.44	3.00	0.16	-	1.53	1.46	-	-	7.12	7.25	-	0.34	0.68	9.77	2.06
3/4	3/4																					
1	-																					
1.5	1	B56C C56C	2	6.50	6.00	12.70 13.68	3.50	2.44	3.00	0.16	-	1.50	-	2.50	1.50	7.12	7.25	-	0.34	0.68	10.64	2.06
2	1.5,2																				11.62	
1.5	1	143TC 145TC	3	6.50	6.00	12.76 13.74	3.50	2.75	4.00 5.00	0.16	-	1.50	-	2.50	1.50	7.12	7.25	-	-	-	10.64	2.12
2	1.5,2																				11.62	
3	3	182TC 184TC	4	8.82	5.90 6.90	14.37 15.40	4.50	3.75	4.50 5.50	0.65	0.41	1.75	-	-	-	9.15	9.37	1.30	-	-	11.75	2.62
5	5																				12.78	
7.5	7.5	213TC 215TC	5	9.85	6.90 8.35	17.78 19.28	5.25	4.25	5.50 7.00	0.70	0.41	1.75	-	-	-	10.60	10.75	1.65	-	-	14.66	3.12
10	10																				16.16	

Output (HP)		Frame No.	Fig. No.	AJ	AK	BA	BB	BC	BD	BF	BS	Key			Keyseat R	Terminal Housing			Shaft Extension		Bearings		
2P	4P													Width	Thick	Length	AA	AB	AC	XB	N-W	U	DE
1/2	1/2	A56C	1	5.875	4.50	2.75	0.16	0.19	6.30	3/8"-16	3.55	0.188	0.188	1.41	0.517	1/2"	5.07	4.13	1.51	1.875	0.625	62052RS	62042RS
3/4	3/4																						
1	-																						
1.5	1	B56C C56C	2	5.875	4.50	2.75	0.16	0.19	6.30	3/8"-16	4.42 5.40	0.188	0.188	1.41	0.517	1/2"	5.07	4.13	1.51	1.875	0.625	62052RS	62042RS
2	1.5,2																						
1.5	1	143TC 145TC	3	5.875	4.50	2.25	0.16	0.13	6.30	3/8"-16	4.60 5.66	0.188	0.188	1.41	0.771	1/2"	5.07	4.13	1.51	2.250	0.875	62052RS	62042RS
2	1.5,2																						
3	3	182TC 184TC	4	7.250	8.50	2.75	0.25	0.13	9.00	1/2"-13	2.25 2.75	0.250	0.250	1.78	0.986	1/2"	8.19	6.26	1.86	2.750	1.125	63062RS	63062RS
5	5																						
7.5	7.5	213TC 215TC	5	7.250	8.50	3.50	0.25	0.26	9.00	1/2"-13	2.75 3.50	0.312	0.312	2.41	1.201	1"	9.59	7.23	2.34	3.380	1.375	63082RS	63062RS
10	10																						

- Note: 1. Dimensions in inches.
 2. Tolerance of U = +0, -0.0005
 3. Tolerance of D = +0, -0.03
 4. Tolerance of R = +0, -0.015
 5. Tolerance of AK: +0, -0.003



PO Box 277, (78680-0277)
 5100N IH 35
 Round Rock, TX 78681
 1-800-451-8798

www.tecowestinghouse.com